

1-Install the double sided grip tape roll onto spool #1 as shown.

2-Pull approximately 6" of tape and pull the backing off to spool #3

3-Pass the double sided tape over Spool #2 and on top of the blade

4-Pull the tape backing to the bottom and around spool #3 and thread the backing through the slit.

5- Rotate Spool #1 anti-clockwise to take out the slack and ensure proper threading.

Please note that the tension is Spool #1 and Spool #3 can be adjusted by tightening the thumb screws as needed.

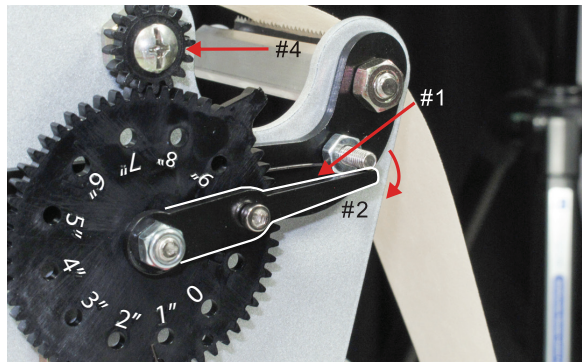

To adjust the dispensed grip tape length:

1- Un-tighten cap screw #1

2- Dial the #2 indicator to the required length 1~11"

3- Tighten cap screw #1 through the desired hole length locator.

Please note: To operate the grip tape dispenser similar to a geared grip tape dispenser, remove gear #4.

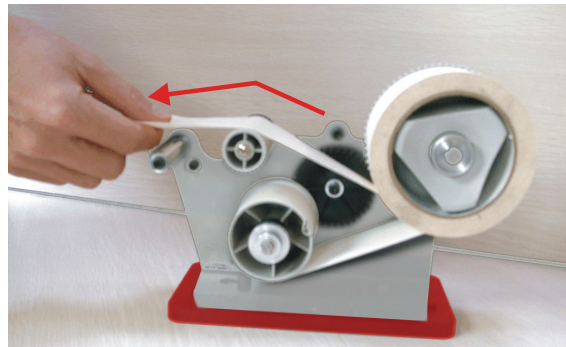

Dispensing tape:

Lift tape off the blade...

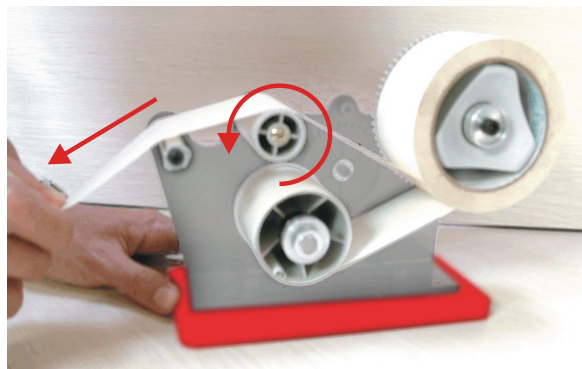

Dispensing tape:

Pull grip tape downward with a steady hand so that the grip tape drags over the metering spool #2... Until the spools lockup...

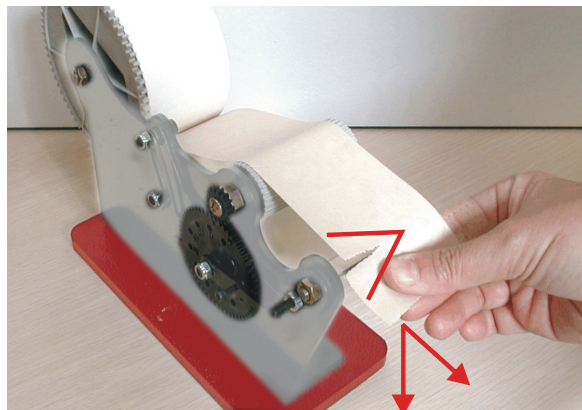

Rip the grip tape over the blade from the inner to the outer edge while pressing down in a swift and deliberate action. The blade holder will automatically collapse, resetting the spools for the next grip tape strip.